

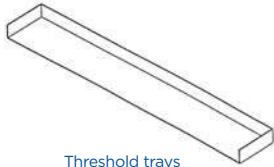

Purpose made cavity trays

Special made to measure damp proof course units for dpc applications



Threshold trays

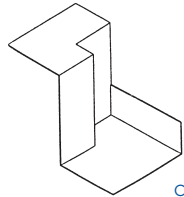

Corner/column stopends

Let us take the load with our **free Cavity Tray specification and scheduling service.**

Contact the Timloc Technical Team for more information.

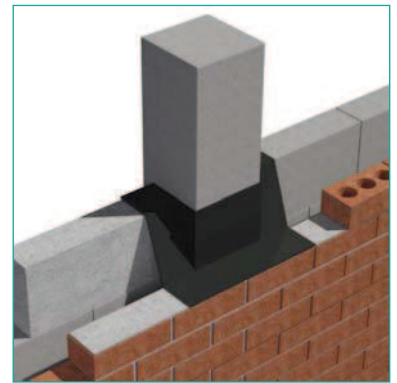

Use

- Wherever DPC is used to form a horizontal cavity tray
- To substitute the cutting, moulding and sealing of a DPC when forming cavity trays, angles, stop ends and column cloaks

Features and benefits

- One piece seamless mouldings eliminate the need for site fabrication to prevent errors through poor workmanship
- Tailor-made to order - manufactured to suit exact customer requirements with delivery to site usually within 10-14 working days
- Easy to handle, flexible, tough, durable and puncture resistant
- Fully compatible with all Timloc DPC and cavity tray systems
- Can be used for multi-storey or high loading applications - will not extrude under loads up to the point of compressive failure of wall
- Wide range of standard components with special, tailor-made accessories also readily available

Quality

- Manufactured to BS EN ISO 9001 and BS EN ISO 14001
- Design principals comply with all relevant Building Regulations and relevant British Standards

Material and colour choice

- Vacuum formed in 2mm medium density polyethylene
- In line heat bending in 2mm polypropylene
- Available in black only

Products in the range

Cavity trays for brick support systems

Pier, column and corner cloaks

Threshold trays

Change of level units

Stop end and junction cappings

Radius units

Ring beam cavity tray systems

Parapet cavity tray systems

Installation advice

- As with all DPC systems, purpose made units should always be bedded on to fresh mortar, never dry bedded. The masonry laid over the DPC and purpose made unit should also be bedded on to fresh mortar so that the DPC system is approximately half way through the thickness of the mortar joint
- Continuation of DPC must be lapped on to the purpose made unit by a minimum of 100mm

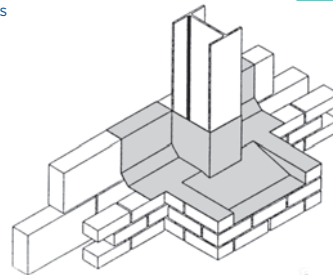

Pier and column cloaks

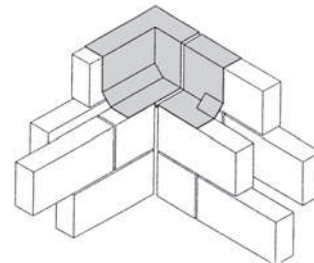

Corner expansion joints

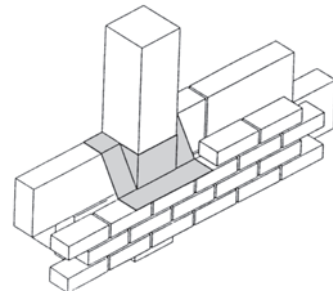

Straight column cloaks

- All lapped joints must be fully sealed with jointing tape (not all units are supplied with jointing tape attached). It is essential that the jointing surfaces are clean and dry or the jointing surfaces will not seal correctly

- All DPC items should be installed to relevant codes of practice

Please see technical section for more details.

How to order

Cavity trays are **made to order**, so please supply full construction details. Ideally these will include a fully dimensioned drawing.

Bill of quantity

NSPlus

F30 Accessories/sundry items for brick/block/stone walling

Clause

385 PREFORMED DPC / CAVITY TRAY JUNCTION CLOAKS / STOPENDS

- Manufacturer: **Timloc Building Products, Rawcliffe Road, Goole, East Yorkshire, DN14 6UQ. Tel: 01405 765567, Fax: 01405 720479. Web: www.timloc.co.uk**

- Type(s) and location(s): Preformed made to measure Cavity tray to be designed to fit around non standard bespoke applications, such as columns, wind posts, corners, lintels etc

- Seal all laps with dpc and/or cavity trays using adhesive/mastic in accordance with manufacturers recommendations to ensure a fully watertight installation.

- Reference: **Timloc Purpose Made Cavity Trays**

- Types shown on drawings.