

1m over fascia vent

Efficient, durable ventilator in convenient 1m lengths

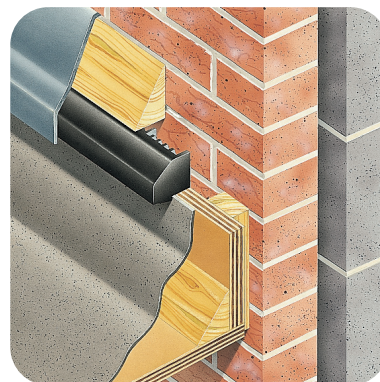
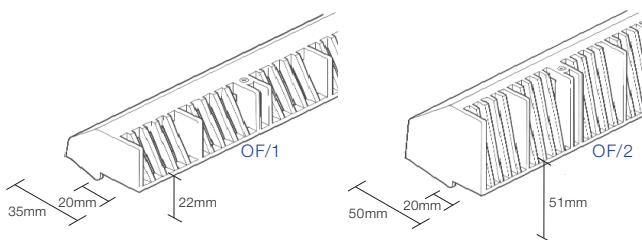

Use

- For roof eaves ventilation
- For flat roof abutment ventilation
- On roofs where the eaves incorporate a fascia board
- On roofs which do not incorporate a soffit board, or where an unbroken soffit board is required

Features and benefits

- Efficient, very unobtrusive and easy to fit
- Superior strength construction - will carry the weight of the bottom row of tiles
- 3.5mm - 4mm wide ventilation slots comply with BS 5250 : 2002
- Durable and totally resistant to decay
- UV stabilised and colourfast
- Supplied in convenient 1m lengths

Quality

- Satisfies all NHBC requirements
- Manufactured to BS EN ISO 9001 : 2000
- Complies with all relevant Building Regulations
- Meets all relevant British Standards

Material and colour choice

- Manufactured by injection moulding in polypropylene
- Available in black only

Installation advice

- Use product OF/1 to ventilate pitched roofs, where the pitch of the roof is 15 degrees or more, and the roof void is attic or loft space
- Use product OF/2 to ventilate pitched roofs, where the pitch of the roof is less than 15 degrees, flat roofs or any roof where living accommodation is contained within the roof space
- Make sure each ventilator is fixed securely into the top of the fascia board using screws or nails through each fixing hole provided
- On pitched roofs it is advisable to provide a felt support above the fascia ventilator. This will prevent the felt from sagging behind the fascia board and will maintain a clear air path at the front
- When ventilating flat roof abutments with product OF/2 some extra joinery work is essential - see the illustration above
- Ventilation must be provided for the full length of the eaves and along both sides of the building to create a cross flow ventilation action

How to order

- Determine whether the roof design requires ventilation equivalent to a continuous 10mm opening (OF/1), or 25mm opening (OF/2)
- Measure the overall length of the eaves to be ventilated and divide by 1m to determine the number of ventilators required

Over fascia ventilator 1000mm (10mm airflow)

Bill of quantity

G20 Carpentry/Timber Framing/First Fixing

Clause

900^ EAVES SOFFIT VENTILATORS

- Manufacturer: **Timloc Building Products, Rawcliffe Road, Goole, East Yorkshire, DN14 6UQ. Tel: 01405 765567, Fax: 01405 720479. Web: www.timloc.co.uk**
- Product Reference: **OF/1**
- Type: **Over Fascia Ventilator (1000mm) 10mm Airflow**
- Colour: (**Black, White**)
- Airway: Provide the equivalent of a continuous opening of not less than **10mm** for the full length of eaves.

Over fascia ventilator 1000mm (25mm airflow)

Bill of quantity

G20 Carpentry/Timber Framing/First Fixing

Clause

900^ EAVES SOFFIT VENTILATORS

- Manufacturer: **Timloc Building Products, Rawcliffe Road, Goole, East Yorkshire, DN14 6UQ. Tel: 01405 765567, Fax: 01405 720479. Web: www.timloc.co.uk**
- Product Reference: **OF/2**
- Type: **Over Fascia Ventilator (1000mm) 25mm Airflow**
- Colour: (**Black, White**)
- Airway: Provide the equivalent of a continuous opening of not less than **25mm** for the full length of eaves.

Product codes

1m over fascia vent

Free airflow	Length	Product code
10,000mm ² per metre	1m	OF/1
25,000mm ² per metre	1m	OF/2